

Func Wall/Floor Motorized



Stable & Ergonomic

Func Wall/Floor Motorized is easy to adjust for different needs. The very stable design is perfect for large heavy displays and touch-sensitive displays. The motorized height adjustment ensures the user to present or interact with the display in an ergonomic position, whether very tall, short, standing up or sitting down. The design includes a storage box for e.g. mini PC, codec or laptop, easily accessed from the front. The box can be locked with a padlock (not supplied).

INFO

Finish: Black
Rec. display size: From 46"
Maximum display weight: 120 kg
Minimum VESA: 200 x 200
Maximum VESA: 400 x 400
Stroke: 500 mm
Storage Box Dimensions [mm]: 550 x 380 x 120

ART. NO.
FMT091001

DESCRIPTION
Func Wall/Floor Motorized

PRODUCT DIMENSIONS [mm]

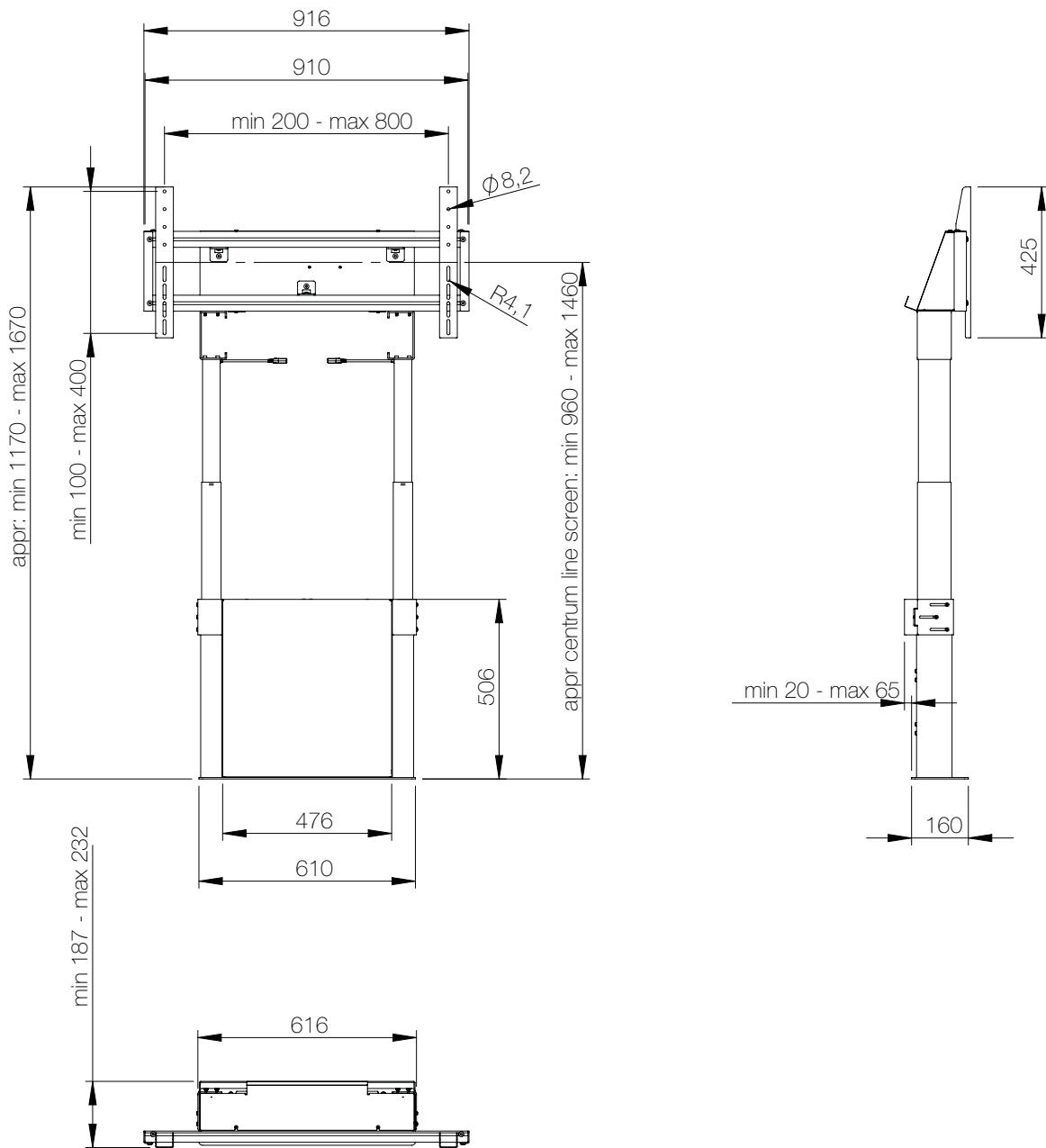

We reserve the right to introduce changes in the product specifications after the printing and publication of this document.